

## 2 . Trunk Type Cable Tray (Cable Duct)

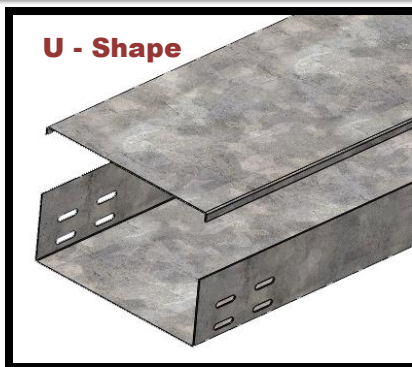
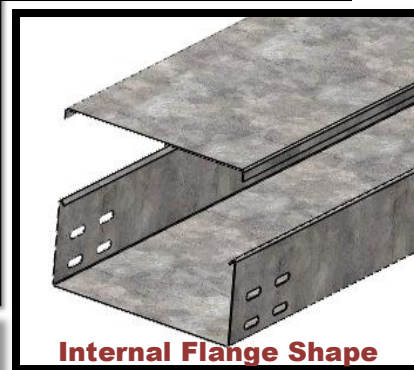
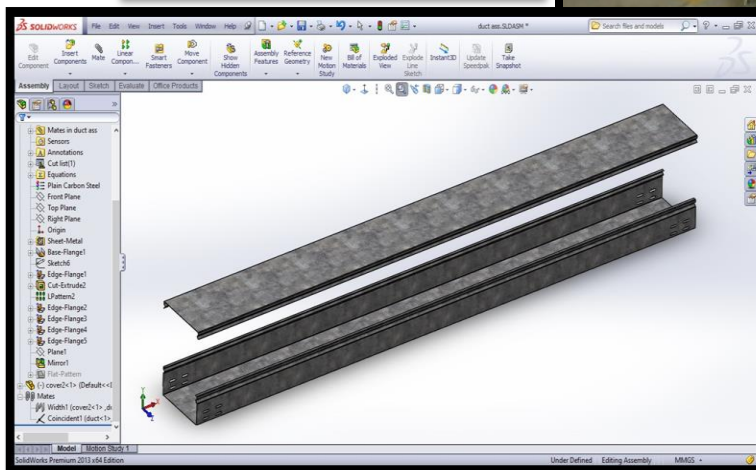

| Code # | Width (W) (mm) | Side Height (H) (mm) | Thickness (mm) |
|--------|----------------|----------------------|----------------|
|--------|----------------|----------------------|----------------|

### 2.1 Trunk Tray Straight Element

|               |     |     |           |
|---------------|-----|-----|-----------|
| PG-TCT50-50   | 50  | 50  | 0.6 – 1.0 |
| PG-TCT50-100  | 100 | 50  | 1.0 – 1.5 |
| PG-TCT50-150  | 150 | 50  | 1.0 – 1.5 |
| PG-TCT50-200  | 200 | 50  | 1.0 – 1.5 |
| PG-TCT50-250  | 250 | 50  | 1.0 – 1.5 |
| PG-TCT50-300  | 300 | 50  | 1.0 – 1.5 |
| PG-TCT50-400  | 400 | 50  | 1.5 – 2.0 |
| PG-TCT50-500  | 500 | 50  | 1.5 – 2.0 |
| PG-TCT50-600  | 600 | 50  | 1.5 – 2.0 |
| PG-TCT75-50   | 50  | 75  | 0.6 – 1.0 |
| PG-TCT75-100  | 100 | 75  | 1.0 – 1.5 |
| PG-TCT75-150  | 150 | 75  | 1.0 – 1.5 |
| PG-TCT75-200  | 200 | 75  | 1.0 – 1.5 |
| PG-TCT75-250  | 250 | 75  | 1.0 – 1.5 |
| PG-TCT75-300  | 300 | 75  | 1.0 – 1.5 |
| PG-TCT75-400  | 400 | 75  | 1.5 – 2.0 |
| PG-TCT75-500  | 500 | 75  | 1.5 – 2.0 |
| PG-TCT75-600  | 600 | 75  | 1.5 – 2.0 |
| PG-TCT100-50  | 50  | 100 | 0.6 – 1.0 |
| PG-TCT100-100 | 100 | 100 | 1.0 – 1.5 |
| PG-TCT100-150 | 150 | 100 | 1.0 – 1.5 |
| PG-TCT100-200 | 200 | 100 | 1.0 – 1.5 |
| PG-TCT100-250 | 250 | 100 | 1.0 – 1.5 |
| PG-TCT100-300 | 300 | 100 | 1.0 – 1.5 |
| PG-TCT100-400 | 400 | 100 | 1.5 – 2.0 |
| PG-TCT100-500 | 500 | 100 | 1.5 – 2.0 |
| PG-TCT100-600 | 600 | 100 | 1.5 – 2.0 |
| PG-TCT110-50  | 50  | 110 | 0.6 – 1.0 |
| PG-TCT110-100 | 100 | 110 | 1.0 – 1.5 |
| PG-TCT110-150 | 150 | 110 | 1.0 – 1.5 |
| PG-TCT110-200 | 200 | 110 | 1.0 – 1.5 |
| PG-TCT110-250 | 250 | 110 | 1.0 – 1.5 |
| PG-TCT110-300 | 300 | 110 | 1.0 – 1.5 |
| PG-TCT110-400 | 400 | 110 | 1.5 – 2.0 |
| PG-TCT110-500 | 500 | 110 | 1.5 – 2.0 |
| PG-TCT110-600 | 600 | 110 | 1.5 – 2.0 |

## 2.1 Trunk Tray Straight Element

### Specifications:

#### Material:

Steel / Stainless Steel / Aluminum

#### Surface Finish:

- Hot-dip galvanized after fabrication according to ASTM A123 & DIN 50976 - zinc coating thickness on one side 50-60  $\mu$  m (350-420 gm<sup>2</sup>)
- Pre galvanized according to DIN 17162 on both sides 275 gm./m.
- Electrostatic Painting.
- Electroplated.

#### Side Standard height:

50 mm – 75 mm – 100 mm – 110 mm

#### Standard Length: 2000 mm & 3000 mm

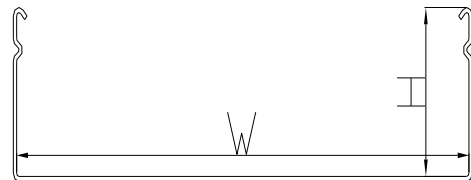
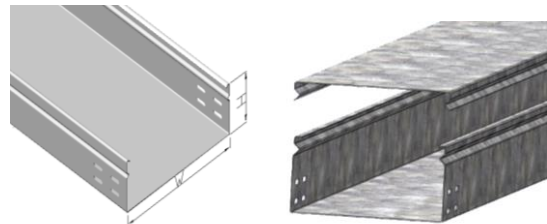

How to order : (Example)

PG-TCT50-100 - S - SOT - HD - T

|                     |                    |                             |                            |                                     |
|---------------------|--------------------|-----------------------------|----------------------------|-------------------------------------|
| Code Description :  | PG : PG-Line       | PCT : Perforated Cable Tray | 50 : Tray Side Height      | 100 : Tray Width                    |
| Material Type :     | S : Steel          | SS : Stainless Steel        | AL : Aluminum              | T: Thickness (1.0/1.25 /1.5 /2.0)mm |
| Type of Tray side : | U : U-Shape        | I : Internal Return Flange  | SOT : Snap-On Tray         |                                     |
| Surface Finish :    | P : Pre-Galvanized | HD : Hot Dip Galvanized     | ES : Electrostatic Painted | EP : Electroplated                  |

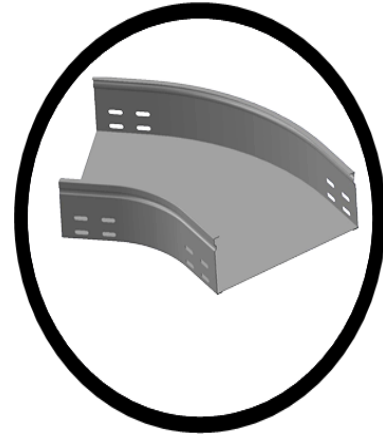
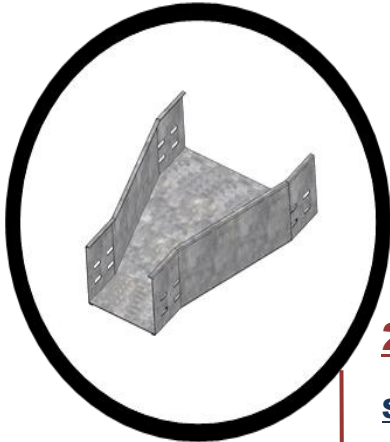

## 2.2 Fittings

### Specifications:

#### Material:

Carbon Steel / Stainless Steel / Aluminum

#### Surface Finish:

Hot- dip galvanized after fabrication according to ASTM A123 & DIN 50976 - zinc coating thickness on one side 50-60  $\mu$  m (350-420 gm<sup>2</sup>)

- Pre galvanized according to DIN 17162 on both sides 275 gm./m.
- Electrostatic Painting.
- Electroplated.

#### Side Standard height:

50 mm - 75 mm - 100 mm - 110 mm

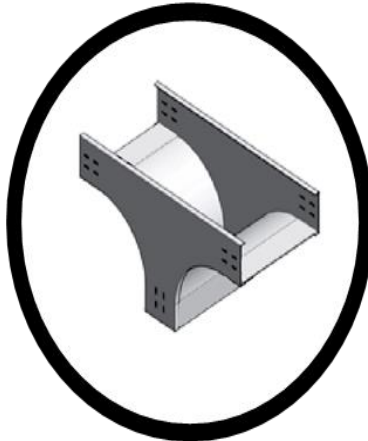
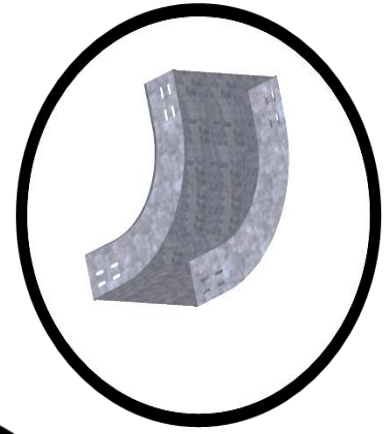
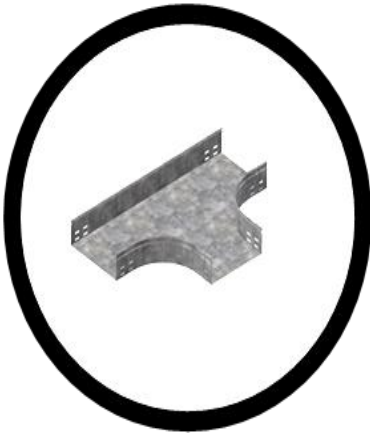

|                     |                    |                                 |                            |                                    |
|---------------------|--------------------|---------------------------------|----------------------------|------------------------------------|
| How to order :      | (Example)          | PG-TCT50-100 - S - SOT - HD - T |                            |                                    |
| Code Description :  | PG : PG-Line       | PCT : Perforated Cable Tray     | 50 : Tray Side Height      | 100 : Tray Width                   |
| Material Type :     | S : Steel          | SS : Stainless Steel            | AL : Aluminum              | T:Thickness (1.0/1.25 /1.5 /2.0)mm |
| Type of Tray side : | U : U-Shape        | I : Internal Return Flange      | SOT : Snap-On Tray         |                                    |
| Surface Finish :    | P : Pre-Galvanized | HD : Hot Dip Galvanized         | ES : Electrostatic Painted | EP : Electroplated                 |

### 2.2.1 Horizontal Elbow 90°

**Specifications:**

**Material:**

Steel / Stainless Steel / Aluminum

**Surface Finish:**

- Hot-dip galvanized after fabrication according to ASTM A123 & DIN 50976 - zinc coating thickness on one side 50-60 μ m (350-420 gm<sup>2</sup>)
- Pre galvanized according to DIN 17162 on both sides 275 gm./m.
- Electrostatic Painting.
- Electroplated.

**Side Standard height:**

50 mm – 75 mm – 100 mm - 110 mm

**Standard Radius: 140 mm & 240 mm**

| Code #                               | Width (mm) | Radius (mm) | Height (mm) |
|--------------------------------------|------------|-------------|-------------|
| <b>2.2.1 Horizontal Elbow 90° :-</b> |            |             |             |
| PG-THE9050 -50                       | 50         | 140         | 50          |
| PG-THE90100-50                       | 100        |             |             |
| PG-THE90200-50                       | 200        |             |             |
| PG-THE90300-50                       | 300        | 240         |             |
| PG-THE90400-50                       | 400        |             |             |
| PG-THE90500-50                       | 500        |             |             |
| PG-THE90600-50                       | 600        | 140         | 75          |
| PG-THE9050 -75                       | 50         |             |             |
| PG-THE90100-75                       | 100        |             |             |
| PG-THE90200-75                       | 200        |             |             |
| PG-THE90300-75                       | 300        |             |             |
| PG-THE90400-75                       | 400        |             |             |
| PG-THE90500-75                       | 500        | 240         |             |
| PG-THE90600-75                       | 600        |             |             |
| PG-THE9050-100                       | 50         |             | 140         |
| PG-THE90100-100                      | 100        |             |             |
| PG-THE90200-100                      | 200        |             |             |
| PG-THE90300-100                      | 300        |             |             |
| PG-THE90400-100                      | 400        |             |             |
| PG-THE90500-100                      | 500        |             |             |
| PG-THE90600-100                      | 600        | 240         |             |
| PG-THE9050 -110                      | 50         |             |             |
| PG-THE90100-110                      | 100        |             | 140         |
| PG-THE90200-110                      | 200        |             |             |
| PG-THE90300-110                      | 300        |             |             |
| PG-THE90400-110                      | 400        |             |             |
| PG-THE90500-110                      | 500        |             |             |
| PG-THE90600-110                      | 600        |             |             |

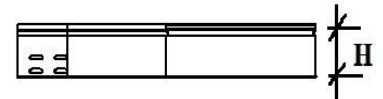
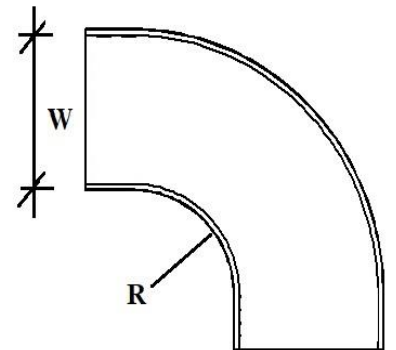
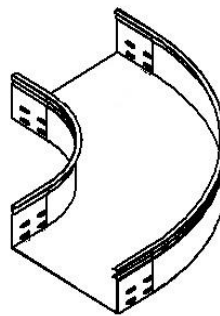
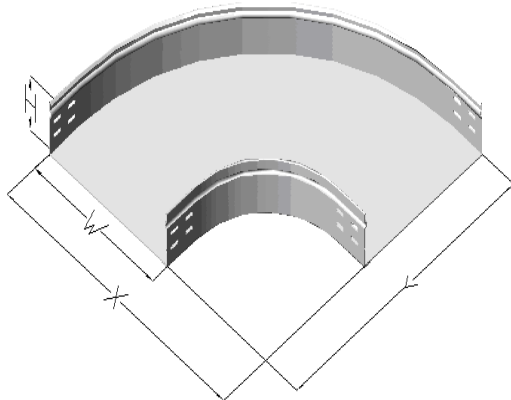

|                     |                    |                                 |                            |                                     |  |
|---------------------|--------------------|---------------------------------|----------------------------|-------------------------------------|--|
| How to order :      | (Example)          | PG-TCT50-100 - S - SOT - HD - T |                            |                                     |  |
| Code Description :  | PG : PG-Line       | PCT : Perforated Cable Tray     | 50 : Tray Side Height      | 100 : Tray Width                    |  |
| Material Type :     | S : Steel          | SS : Stainless Steel            | AL : Aluminum              | T: Thickness (1.0/1.25 /1.5 /2.0)mm |  |
| Type of Tray side : | U : U-Shape        | I : Internal Return Flange      | SOT : Snap-On Tray         |                                     |  |
| Surface Finish :    | P : Pre-Galvanized | HD : Hot Dip Galvanized         | ES : Electrostatic Painted | EP : Electroplated                  |  |

| Code #                                          | Width (mm) | Radius (mm) | Height (mm) |
|-------------------------------------------------|------------|-------------|-------------|
| <b>2.2.2 Trunk Type Horizontal Elbow 45° :-</b> |            |             |             |
| PG-THE450 -50                                   | 50         | 140         | 50          |
| PG-THE450100-50                                 | 100        |             |             |
| PG-THE45200-50                                  | 200        |             |             |
| PG-THE45300-50                                  | 300        |             |             |
| PG-THE45400-50                                  | 400        |             |             |
| PG-THE45500-50                                  | 500        |             |             |
| PG-THE45600-50                                  | 600        | 240         | 50          |
| PG-THE4550 -75                                  | 50         |             |             |
| PG-THE45100-75                                  | 100        |             |             |
| PG-THE45200-75                                  | 200        |             |             |
| PG-THE45300-75                                  | 300        |             |             |
| PG-THE45400-75                                  | 400        |             |             |
| PG-THE45500-75                                  | 500        | 140         | 75          |
| PG-THE45600-75                                  | 600        |             |             |
| PG-THE4550-100                                  | 50         |             |             |
| PG-THE45100-100                                 | 100        |             |             |
| PG-THE45200-100                                 | 200        |             |             |
| PG-THE45300-100                                 | 300        |             |             |
| PG-THE45400-100                                 | 400        | 240         | 100         |
| PG-THE45500-100                                 | 500        |             |             |
| PG-THE45600-100                                 | 600        |             |             |
| PG-THE4550 -110                                 | 50         |             |             |
| PG-T HE45100-110                                | 100        |             |             |
| PG-T HE45200-110                                | 200        |             |             |
| PG-T HE45300-110                                | 300        | 140         | 110         |
| PG-T HE45400-110                                | 400        |             |             |
| PG-T HE45500-110                                | 500        |             |             |
| PG-T HE45600-110                                | 600        |             |             |
| PG-T HE45300-110                                | 300        |             |             |
| PG-T HE45400-110                                | 400        |             |             |
| PG-T HE45500-110                                | 500        | 240         | 110         |
| PG-T HE45600-110                                | 600        |             |             |
| PG-T HE45300-110                                | 300        |             |             |
| PG-T HE45400-110                                | 400        |             |             |
| PG-T HE45500-110                                | 500        |             |             |
| PG-T HE45600-110                                | 600        |             |             |

### 2.2.2 Trunk Type Horizontal Elbow 45°

#### Specifications:

#### Material:

Steel / Stainless Steel / Aluminum

#### Surface Finish:

- Hot- dip galvanized after fabrication according to ASTM A123 & DIN 50976 - zinc coating thickness on one side 50-60 μ m (350-420 gm<sup>2</sup>)
- Pre galvanized according to DIN 17162 on both sides 275 gm./m.
- Electrostatic Painting.
- Electroplated.

#### Side Standard height:

50 mm – 75 mm – 100 mm - 110 mm

**Standard Radius:** 140 mm & 240 mm

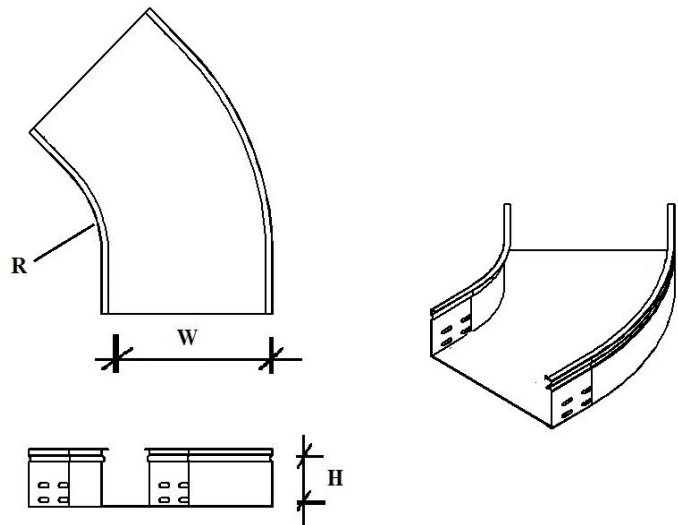
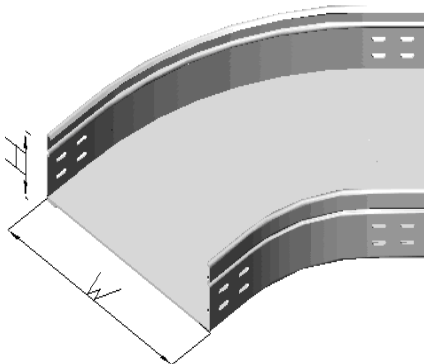

|                     |                    |                                 |                            |                                     |  |
|---------------------|--------------------|---------------------------------|----------------------------|-------------------------------------|--|
| How to order :      | (Example)          | PG-TCT50-100 - S - SOT - HD - T |                            |                                     |  |
| Code Description :  | PG : PG-Line       | PCT : Perforated Cable Tray     | 50 : Tray Side Height      | 100 : Tray Width                    |  |
| Material Type :     | S : Steel          | SS : Stainless Steel            | AL : Aluminum              | T: Thickness (1.0/1.25 /1.5 /2.0)mm |  |
| Type of Tray side : | U : U-Shape        | I : Internal Return Flange      | SOT : Snap-On Tray         |                                     |  |
| Surface Finish :    | P : Pre-Galvanized | HD : Hot Dip Galvanized         | ES : Electrostatic Painted | EP : Electroplated                  |  |

| Code #                                               | Width (mm) | Radius (mm) | Height (mm) |     |
|------------------------------------------------------|------------|-------------|-------------|-----|
| <b>2.2.3 Trunk Type Vertical Inside Elbow 90° :-</b> |            |             |             |     |
| PG-TVIE9050 -50                                      | 50         | 140         | 50          |     |
| PG-TVIE90100-50                                      | 100        |             |             |     |
| PG-TVIE90200-50                                      | 200        |             |             |     |
| PG-TVIE90300-50                                      | 300        | 240         |             |     |
| PG-TVIE90400-50                                      | 400        |             |             |     |
| PG-TVIE90500-50                                      | 500        |             |             |     |
| PG-TVIE90600-50                                      | 600        | 140         | 75          |     |
| PG-TVIE9050 -75                                      | 50         |             |             |     |
| PG-TVIE90100-75                                      | 100        |             |             |     |
| PG-TVIE90200-75                                      | 200        |             |             |     |
| PG-TVIE90300-75                                      | 300        |             |             |     |
| PG-TVIE90400-75                                      | 400        |             |             |     |
| PG-TVIE90500-75                                      | 500        | 240         |             |     |
| PG-TVIE90600-75                                      | 600        |             |             |     |
| PG-TVIE9050-100                                      | 50         |             |             | 140 |
| PG-TVIE90100-100                                     | 100        |             |             |     |
| PG-TVIE90200-100                                     | 200        |             |             |     |
| PG-TVIE90300-100                                     | 300        | 240         |             |     |
| PG-TVIE90400-100                                     | 400        |             |             |     |
| PG-TVIE90500-100                                     | 500        |             |             |     |
| PG-TVIE90600-100                                     | 600        | 140         | 110         |     |
| PG-TVIE9050 -110                                     | 50         |             |             |     |
| PG-TVIE90100-110                                     | 100        |             |             |     |
| PG-TVIE90200-110                                     | 200        |             |             |     |
| PG-TVIE90300-110                                     | 300        |             |             | 240 |
| PG-TVIE90400-110                                     | 400        |             |             |     |
| PG-TVIE90500-110                                     | 500        |             |             |     |
| PG-TVIE90600-110                                     | 600        |             |             |     |

### 2.2.3 Trunk Type Vertical Inside Elbow 90°

**Specifications:**

**Material:**

Steel / Stainless Steel / Aluminum

**Surface Finish:**

- Hot-dip galvanized after fabrication according to ASTM A123 & DIN 50976 - zinc coating thickness on one side 50-60 μ m (350-420 gm<sup>2</sup>)
- Pre galvanized according to DIN 17162 on both sides 275 gm./m.
- Electrostatic Painting.
- Electroplated.

**Side Standard height:**

50 mm – 75 mm – 100 mm - 110 mm

**Standard Radius: 140 mm & 240 mm**

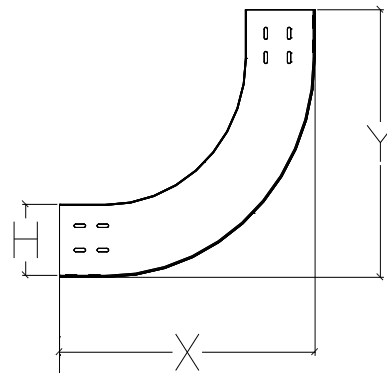
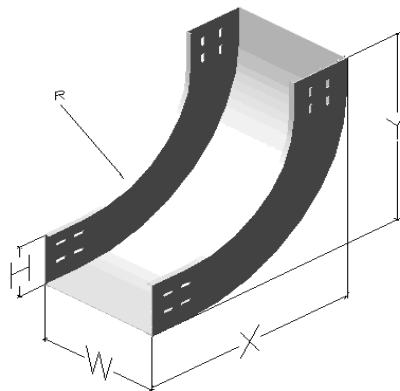

|                     |                                           |                             |                            |                                     |
|---------------------|-------------------------------------------|-----------------------------|----------------------------|-------------------------------------|
| How to order :      | (Example) PG-TCT50-100 - S - SOT - HD - T |                             |                            |                                     |
| Code Description :  | PG : PG-Line                              | PCT : Perforated Cable Tray | 50 : Tray Side Height      | 100 : Tray Width                    |
| Material Type :     | S : Steel                                 | SS : Stainless Steel        | AL : Aluminum              | T: Thickness (1.0/1.25 /1.5 /2.0)mm |
| Type of Tray side : | U : U-Shape                               | I : Internal Return Flange  | SOT : Snap-On Tray         |                                     |
| Surface Finish :    | P : Pre-Galvanized                        | HD : Hot Dip Galvanized     | ES : Electrostatic Painted | EP : Electroplated                  |

| Code #                                             | Width (mm) | Radius (mm) | Height (mm) |
|----------------------------------------------------|------------|-------------|-------------|
| <b>2.2.5 Trunk Type Vertical Outside Elbow 90°</b> |            |             |             |
| PG-TVOE9050-50                                     | 50         | 140         | 50          |
| PG-TVOE90100-50                                    | 100        |             |             |
| PG-TVOE90200-50                                    | 200        |             |             |
| PG-TVOE90300-50                                    | 300        |             |             |
| PG-TVOE90400-50                                    | 400        |             |             |
| PG-TVOE90500-50                                    | 500        |             |             |
| PG-TVOE90600-50                                    | 600        | 240         | 50          |
| PG-TVOE9050-75                                     | 50         |             |             |
| PG-TVOE90100-75                                    | 100        |             |             |
| PG-TVOE90200-75                                    | 200        |             |             |
| PG-TVOE90300-75                                    | 300        |             |             |
| PG-TVOE90400-75                                    | 400        |             |             |
| PG-TVOE90500-75                                    | 500        | 140         | 75          |
| PG-TVOE90600-75                                    | 600        |             |             |
| PG-TVOE9050-100                                    | 50         |             |             |
| PG-TVOE90100-100                                   | 100        |             |             |
| PG-TVOE90200-100                                   | 200        |             |             |
| PG-TVOE90300-100                                   | 300        |             |             |
| PG-TVOE90400-100                                   | 400        | 240         | 100         |
| PG-TVOE90500-100                                   | 500        |             |             |
| PG-TVOE90600-100                                   | 600        |             |             |
| PG-TVOE9050-110                                    | 50         |             |             |
| PG-TVOE90100-110                                   | 100        |             |             |
| PG-TVOE90200-110                                   | 200        |             |             |
| PG-TVOE90300-110                                   | 300        | 140         | 110         |
| PG-TVOE90400-110                                   | 400        |             |             |
| PG-TVOE90500-110                                   | 500        |             |             |
| PG-TVOE90600-110                                   | 600        |             |             |
| PG-TVOE9050-110                                    | 50         |             |             |
| PG-TVOE90600-110                                   | 600        |             |             |

### 2.2.5 Trunk Type Vertical Outside Elbow 90°

#### Specifications:

#### Material:

Steel / Stainless Steel / Aluminum

#### Surface Finish:

- Hot-dip galvanized after fabrication according to ASTM A123 & DIN 50976 - zinc coating thickness on one side 50-60  $\mu$  m (350-420 gm<sup>2</sup>)
- Pre galvanized according to DIN 17162 on both sides 275 gm./m.
- Electrostatic Painting.
- Electroplated.

#### Side Standard height:

50 mm – 75 mm – 100 mm - 110 mm

**Standard Radius: 140 mm & 240 mm**

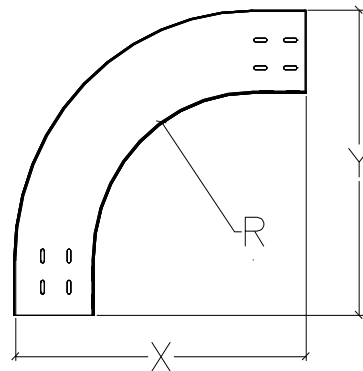
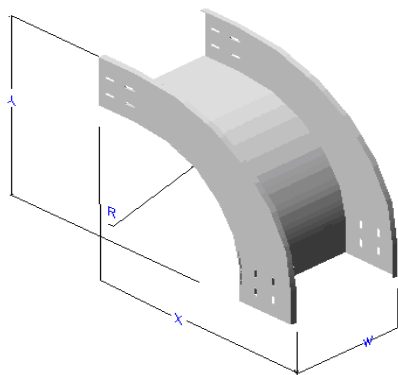

|                     |                    |                                 |                            |                                     |  |
|---------------------|--------------------|---------------------------------|----------------------------|-------------------------------------|--|
| How to order :      | (Example)          | PG-TCT50-100 - S - SOT - HD - T |                            |                                     |  |
| Code Description :  | PG : PG-Line       | PCT : Perforated Cable Tray     | 50 : Tray Side Height      | 100 : Tray Width                    |  |
| Material Type :     | S : Steel          | SS : Stainless Steel            | AL : Aluminum              | T: Thickness (1.0/1.25 /1.5 /2.0)mm |  |
| Type of Tray side : | U : U-Shape        | I : Internal Return Flange      | SOT : Snap-On Tray         |                                     |  |
| Surface Finish :    | P : Pre-Galvanized | HD : Hot Dip Galvanized         | ES : Electrostatic Painted | EP : Electroplated                  |  |

| Code #                                                | Width (mm) | Radius (mm) | Height (mm) |     |
|-------------------------------------------------------|------------|-------------|-------------|-----|
| <b>2.2.6 Trunk Type Vertical Outside Elbow 45° :-</b> |            |             |             |     |
| PG-TVOE4550 -50                                       | 50         | 140         | 50          |     |
| PG- TVOE45100-50                                      | 100        |             |             |     |
| PG- TVOE45200-50                                      | 200        |             |             |     |
| PG- TVOE45300-50                                      | 300        | 240         |             |     |
| PG- TVOE45400-50                                      | 400        |             |             |     |
| PG- TVOE45500-50                                      | 500        |             |             |     |
| PG- TVOE45600-50                                      | 600        | 140         | 75          |     |
| PG-TVOE4550 -75                                       | 50         |             |             |     |
| PG- TVOE45100-75                                      | 100        |             |             |     |
| PG- TVOE45200-75                                      | 200        |             |             |     |
| PG- TVOE45300-75                                      | 300        |             |             | 240 |
| PG- TVOE45400-75                                      | 400        |             |             |     |
| PG- TVOE45500-75                                      | 500        |             |             |     |
| PG- TVOE45600-75                                      | 600        | 140         |             | 100 |
| PG-TVOE4550-100                                       | 50         |             |             |     |
| PG- TVOE45100-100                                     | 100        |             |             |     |
| PG- TVOE45200-100                                     | 200        |             |             |     |
| PG- TVOE45300-100                                     | 300        |             |             |     |
| PG- TVOE45400-100                                     | 400        |             |             |     |
| PG- TVOE45500-100                                     | 500        |             |             |     |
| PG- TVOE45600-100                                     | 600        | 140         | 110         |     |
| PG-TVOE4550 -110                                      | 50         |             |             |     |
| PG- TVOE45100-110                                     | 100        |             |             |     |
| PG- TVOE45200-110                                     | 200        |             |             |     |
| PG- TVOE45300-110                                     | 300        |             |             | 240 |
| PG- TVOE45400-110                                     | 400        |             |             |     |
| PG- TVOE45500-110                                     | 500        |             |             |     |
| PG- TVOE45600-110                                     | 600        |             |             |     |

### 2.2.6 Trunk Type Vertical Outside Elbow 45°

#### Specifications:

#### Material:

Steel / Stainless Steel / Aluminum

#### Surface Finish:

- Hot- dip galvanized after fabrication according to ASTM A123 & DIN 50976 - zinc coating thickness on one side 50-60 μ m (350-420 gm<sup>2</sup>)
- Pre galvanized according to DIN 17162 on both sides 275 gm./m.
- Electrostatic Painting.
- Electroplated.

#### Side Standard height:

50 mm – 75 mm – 100 mm - 110 mm

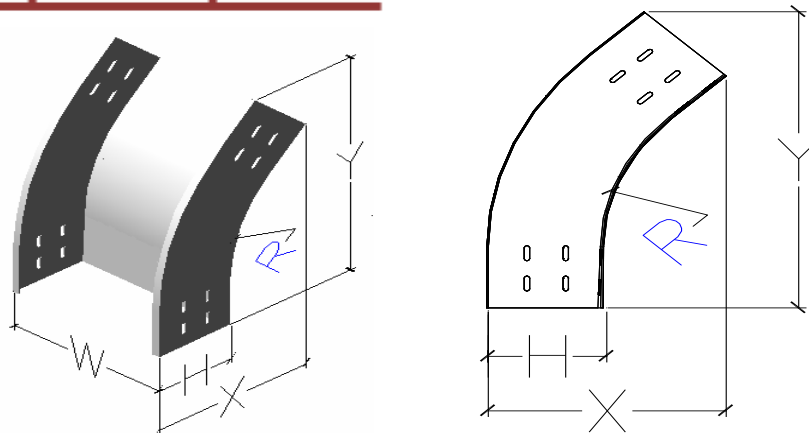

|                     |                    |                                 |                            |                                     |  |
|---------------------|--------------------|---------------------------------|----------------------------|-------------------------------------|--|
| How to order :      | (Example)          | PG-TCT50-100 - S - SOT - HD - T |                            |                                     |  |
| Code Description :  | PG : PG-Line       | PCT : Perforated Cable Tray     | 50 : Tray Side Height      | 100 : Tray Width                    |  |
| Material Type :     | S : Steel          | SS : Stainless Steel            | AL : Aluminum              | T: Thickness (1.0/1.25 /1.5 /2.0)mm |  |
| Type of Tray side : | U : U-Shape        | I : Internal Return Flange      | SOT : Snap-On Tray         |                                     |  |
| Surface Finish :    | P : Pre-Galvanized | HD : Hot Dip Galvanized         | ES : Electrostatic Painted | EP : Electroplated                  |  |

| Code #                                 | Width (mm) | Radius (mm) | Height (mm) |
|----------------------------------------|------------|-------------|-------------|
| <b>2.2.7 Trunk Type Horizontal Tee</b> |            |             |             |
| PG-THT50-50                            | 50         | 140         | 50          |
| PG-THT100-50                           | 100        |             |             |
| PG-THT200-50                           | 200        |             |             |
| PG-THT300-50                           | 300        |             |             |
| PG-THT400-50                           | 400        |             |             |
| PG-THT500-50                           | 500        |             |             |
| PG-THT600-50                           | 600        | 240         | 50          |
| PG-THT50-75                            | 50         |             |             |
| PG-THT100-75                           | 100        |             |             |
| PG-THT200-75                           | 200        |             |             |
| PG-THT300-75                           | 300        |             |             |
| PG-THT400-75                           | 400        |             |             |
| PG-THT500-75                           | 500        | 140         | 75          |
| PG-THT600-75                           | 600        |             |             |
| PG-THT50-100                           | 50         |             |             |
| PG-THT100-100                          | 100        |             |             |
| PG-THT200-100                          | 200        |             |             |
| PG-THT300-100                          | 300        |             |             |
| PG-THT400-100                          | 400        | 240         | 100         |
| PG-THT500-100                          | 500        |             |             |
| PG-THT600-100                          | 600        |             |             |
| PG-THT50-110                           | 50         |             |             |
| PG-THT100-110                          | 100        |             |             |
| PG-THT200-110                          | 200        |             |             |
| PG-THT300-110                          | 300        | 140         | 110         |
| PG-THT400-110                          | 400        |             |             |
| PG-THT500-110                          | 500        |             |             |
| PG-THT600-110                          | 600        |             |             |
| PG-THT50-110                           | 50         |             |             |
| PG-THT600-110                          | 600        |             |             |

### 2.2.7 Trunk Type Horizontal Tee

**Specifications:**

**Material:**

Steel / Stainless Steel / Aluminum

**Surface Finish:**

- Hot- dip galvanized after fabrication according to ASTM A123 & DIN 50976 - zinc coating thickness on one side 50-60 μ m (350-420 gm<sup>2</sup>)
- Pre galvanized according to DIN 17162 on both sides 275 gm./m.
- Electrostatic Painting.
- Electroplated.

**Side Standard height:**

50 mm – 75 mm – 100 mm - 110 mm

**Standard Radius:** 140 mm & 240 mm

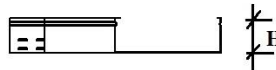
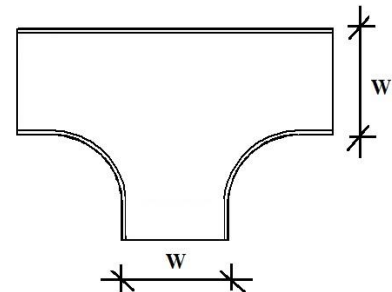
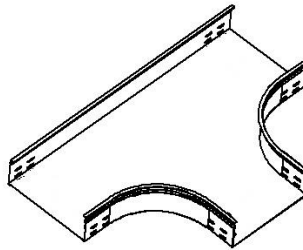
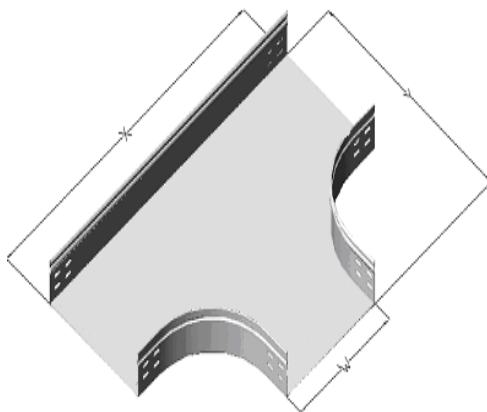

|                     |                    |                                 |                            |                                     |  |
|---------------------|--------------------|---------------------------------|----------------------------|-------------------------------------|--|
| How to order :      | (Example)          | PG-TCT50-100 - S - SOT - HD - T |                            |                                     |  |
| Code Description :  | PG : PG-Line       | PCT : Perforated Cable Tray     | 50 : Tray Side Height      | 100 : Tray Width                    |  |
| Material Type :     | S : Steel          | SS : Stainless Steel            | AL : Aluminum              | T: Thickness (1.0/1.25 /1.5 /2.0)mm |  |
| Type of Tray side : | U : U-Shape        | I : Internal Return Flange      | SOT : Snap-On Tray         |                                     |  |
| Surface Finish :    | P : Pre-Galvanized | HD : Hot Dip Galvanized         | ES : Electrostatic Painted | EP : Electroplated                  |  |

| Code #                               | Width (mm) | Radius (mm) | Height (mm) |
|--------------------------------------|------------|-------------|-------------|
| <b>2.2.8 Trunk Type Vertical Tee</b> |            |             |             |
| PG-TVT50-50                          | 50         | 140         | 50          |
| PG-TVT100-50                         | 100        |             |             |
| PG-TVT200-50                         | 200        |             |             |
| PG-TVT300-50                         | 300        |             |             |
| PG-TVT400-50                         | 400        |             |             |
| PG-TVT500-50                         | 500        |             |             |
| PG-TVT600-50                         | 600        | 240         | 50          |
| PG-TVT50-75                          | 50         |             |             |
| PG-TVT 100-75                        | 100        |             |             |
| PG-TVT200-75                         | 200        |             |             |
| PG-TVT300-75                         | 300        |             |             |
| PG-TVT400-75                         | 400        |             |             |
| PG-TVT500-75                         | 500        | 140         | 75          |
| PG-TVT600-75                         | 600        |             |             |
| PG-TVT50-100                         | 50         |             |             |
| PG-TVT100-100                        | 100        |             |             |
| PG-TVT200-100                        | 200        |             |             |
| PG-TVT300-100                        | 300        |             |             |
| PG-TVT400-100                        | 400        | 240         | 100         |
| PG-TVT500-100                        | 500        |             |             |
| PG-TVT600-100                        | 600        |             |             |
| PG-TVT50-110                         | 50         |             |             |
| PG-TVT100-110                        | 100        |             |             |
| PG-TVT200-110                        | 200        |             |             |
| PG-TVT300-110                        | 300        | 140         | 110         |
| PG-TVT400-110                        | 400        |             |             |
| PG-TVT500-110                        | 500        |             |             |
| PG-TVT600-110                        | 600        |             |             |
| PG-TVT50-110                         | 50         |             |             |
| PG-TVT100-110                        | 100        |             |             |
| PG-TVT200-110                        | 200        | 240         | 110         |
| PG-TVT300-110                        | 300        |             |             |
| PG-TVT400-110                        | 400        |             |             |
| PG-TVT500-110                        | 500        |             |             |
| PG-TVT600-110                        | 600        |             |             |
| PG-TVT50-110                         | 50         |             |             |

### 2.2.8 Trunk Type Vertical Tee

#### Specifications:

#### Material:

Steel / Stainless Steel / Aluminum

#### Surface Finish:

- Hot- dip galvanized after fabrication according to ASTM A123 & DIN 50976 - zinc coating thickness on one side 50-60  $\mu$  m (350-420  $gm^2$ )
- Pre galvanized according to DIN 17162 on both sides 275 gm./m.
- Electrostatic Painting.
- Electroplated.

#### Side Standard height:

50 mm – 75 mm – 100 mm - 110 mm

**Standard Radius: 140 mm & 240 mm**

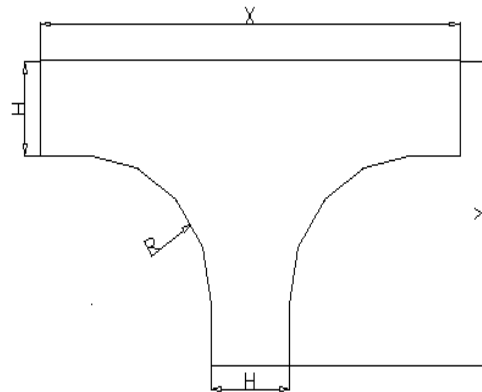
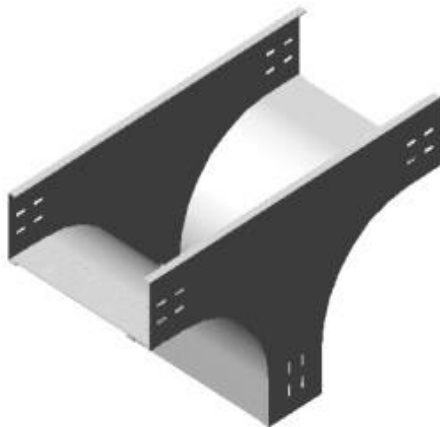

|                     |                    |                                 |                            |                                     |  |
|---------------------|--------------------|---------------------------------|----------------------------|-------------------------------------|--|
| How to order :      | (Example)          | PG-TCT50-100 - S - SOT - HD - T |                            |                                     |  |
| Code Description :  | PG : PG-Line       | PCT : Perforated Cable Tray     | 50 : Tray Side Height      | 100 : Tray Width                    |  |
| Material Type :     | S : Steel          | SS : Stainless Steel            | AL : Aluminum              | T: Thickness (1.0/1.25 /1.5 /2.0)mm |  |
| Type of Tray side : | U : U-Shape        | I : Internal Return Flange      | SOT : Snap-On Tray         |                                     |  |
| Surface Finish :    | P : Pre-Galvanized | HD : Hot Dip Galvanized         | ES : Electrostatic Painted | EP : Electroplated                  |  |

| Code #                                   | Width (mm) | Radius (mm) | Height (mm) |
|------------------------------------------|------------|-------------|-------------|
| <b>2.2.9 Trunk Tray Horizontal Cross</b> |            |             |             |
| PG-THC50 -50                             | 50         | 140         | 50          |
| PG-THC100-50                             | 100        |             |             |
| PG-THC200-50                             | 200        |             |             |
| PG-THC300-50                             | 300        |             |             |
| PG-THC400-50                             | 400        |             |             |
| PG-THC500-50                             | 500        |             |             |
| PG-THC600-50                             | 600        | 240         | 50          |
| PG-THC50 -75                             | 50         |             |             |
| PG-THC100-75                             | 100        |             |             |
| PG-THC200-75                             | 200        |             |             |
| PG-THC300-75                             | 300        |             |             |
| PG-THC400-75                             | 400        |             |             |
| PG-THC500-75                             | 500        | 240         | 75          |
| PG-THC600-75                             | 600        |             |             |
| PG-THC50-100                             | 50         |             |             |
| PG-THC100-100                            | 100        |             |             |
| PG-THC200-100                            | 200        |             |             |
| PG-THC300-100                            | 300        |             |             |
| PG-THC400-100                            | 400        | 240         | 100         |
| PG-THC500-100                            | 500        |             |             |
| PG-THC600-100                            | 600        |             |             |
| PG-THC50-110                             | 50         |             |             |
| PG-THC100-110                            | 100        |             |             |
| PG-THC200-110                            | 200        |             |             |
| PG-THC300-110                            | 300        | 240         | 110         |
| PG-THC400-110                            | 400        |             |             |
| PG-THC500-110                            | 500        |             |             |
| PG-THC600-110                            | 600        |             |             |

### 2.2.9 Trunk Tray Horizontal Cross

#### Specifications:

#### Material:

Steel / Stainless Steel / Aluminum

#### Surface Finish:

- Hot-dip galvanized after fabrication according to ASTM A123 & DIN 50976 - zinc coating thickness on one side 50-60  $\mu$ m (350-420 gm<sup>2</sup>)
- Pre galvanized according to DIN 17162 on both sides 275 gm./m.
- Electrostatic Painting.
- Electroplated.

#### Side Standard height:

50 mm - 75 mm - 100 mm - 110 mm

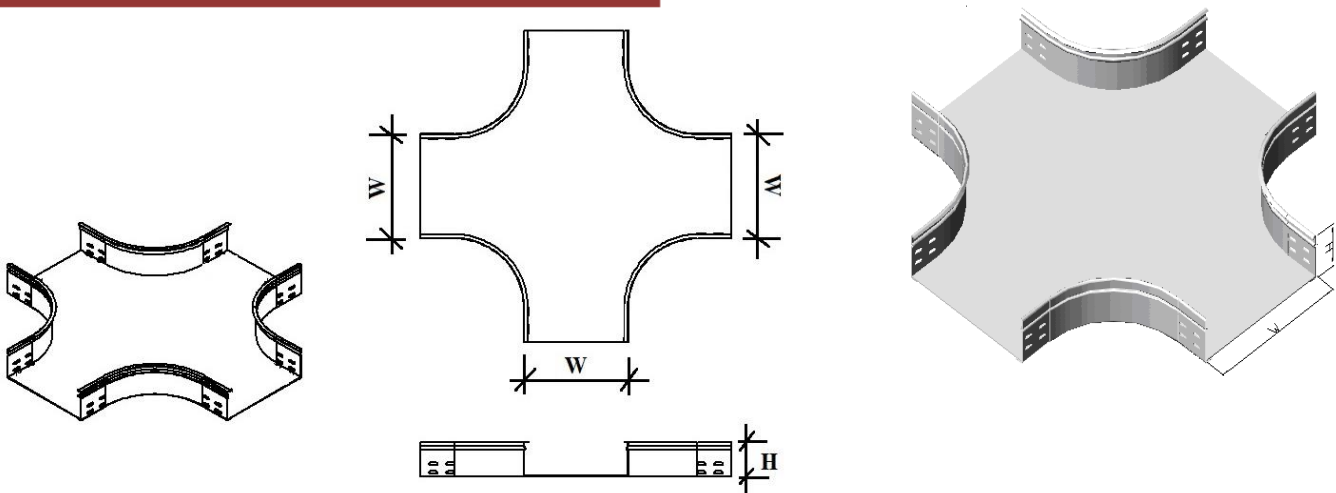

#### Standard Radius: 140 mm & 240 mm



|                     |                    |                                 |                            |                                     |  |
|---------------------|--------------------|---------------------------------|----------------------------|-------------------------------------|--|
| How to order :      | (Example)          | PG-TCT50-100 - S - SOT - HD - T |                            |                                     |  |
| Code Description :  | PG : PG-Line       | PCT : Perforated Cable Tray     | 50 : Tray Side Height      | 100 : Tray Width                    |  |
| Material Type :     | S : Steel          | SS : Stainless Steel            | AL : Aluminum              | T: Thickness (1.0/1.25 /1.5 /2.0)mm |  |
| Type of Tray side : | U : U-Shape        | I : Internal Return Flange      | SOT : Snap-On Tray         |                                     |  |
| Surface Finish :    | P : Pre-Galvanized | HD : Hot Dip Galvanized         | ES : Electrostatic Painted | EP : Electroplated                  |  |

| Code # | Width(mm)<br>W2/W1 | Length<br>(mm) | Shape |
|--------|--------------------|----------------|-------|
|--------|--------------------|----------------|-------|

### 2.2.10 Trunk Horizontal Reducers

|             |          |     |                                                                                     |
|-------------|----------|-----|-------------------------------------------------------------------------------------|
| PG-THRCN200 | 200/100  | 500 |    |
| PG-THRCN300 | 300/---- |     |                                                                                     |
| PG-THRCN400 | 400/---- |     |                                                                                     |
| PG-THRCN500 | 500/---- |     |                                                                                     |
| PG-THRCN600 | 600/---- |     |                                                                                     |
| PG-THRCN700 | 700/---- |     |                                                                                     |
| PG-THRCN800 | 800/---- |     |                                                                                     |
| PG-THRRH200 | 200/100  |     |                                                                                     |
| PG-THRRH300 | 300/---- |     |                                                                                     |
| PG-THRRH400 | 400/---- |     |                                                                                     |
| PG-THRRH500 | 500/---- |     |                                                                                     |
| PG-THRRH600 | 600/---- |     |                                                                                     |
| PG-THRRH700 | 700/---- |     |                                                                                     |
| PG-THRRH800 | 800/---- |     |                                                                                     |
| PG-THRLH200 | 200/100  | 500 |  |
| PG-THRLH300 | 300/---- |     |                                                                                     |
| PG-THRLH400 | 400/---- |     |                                                                                     |
| PG-THRLH500 | 500/---- |     |                                                                                     |
| PG-THRLH600 | 600/---- |     |                                                                                     |
| PG-THRLH700 | 700/---- |     |                                                                                     |
| PG-THRLH800 | 800/---- |     |                                                                                     |

### 2.2.10 Trunk Horizontal Reducer

**Material:**

Steel / Stainless Steel / Aluminum

**Surface Finish:**

Hot-dip galvanized after fabrication according to ASTM A123 & DIN 50976 - zinc coating thickness on one side 50-60 μm (350-420 gm<sup>2</sup>)

- Pre galvanized according to DIN 17162 on both sides 275 gm./m.
- Electrostatic Painting.
- Electroplated.

**Side Standard height:**

50 mm – 75 mm – 100 mm - 110 mm

**Standard Length: 500 mm**

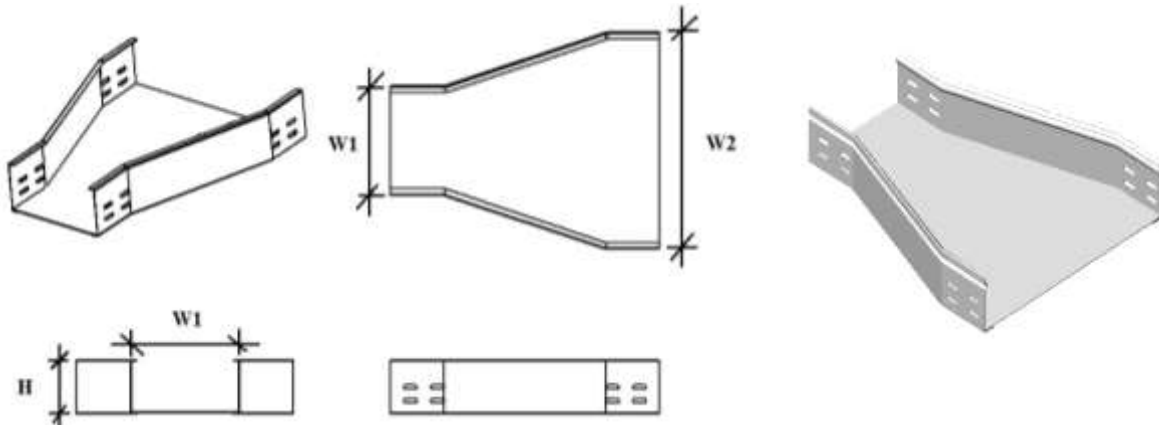

|                     |                    |                                 |                            |                                     |
|---------------------|--------------------|---------------------------------|----------------------------|-------------------------------------|
| How to order :      | (Example)          | PG-TCT50-100 - S - SOT - HD - T |                            |                                     |
| Code Description :  | PG : PG-Line       | PCT : Perforated Cable Tray     | 50 : Tray Side Height      | 100 : Tray Width                    |
| Material Type :     | S : Steel          | SS : Stainless Steel            | AL : Aluminum              | T: Thickness (1.0/1.25 /1.5 /2.0)mm |
| Type of Tray side : | U : U-Shape        | I : Internal Return Flange      | SOT : Snap-On Tray         |                                     |
| Surface Finish :    | P : Pre-Galvanized | HD : Hot Dip Galvanized         | ES : Electrostatic Painted | EP : Electroplated                  |

**2.2.11 Adjustable change level connectors**

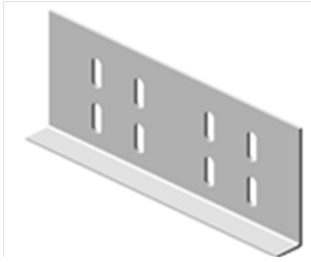
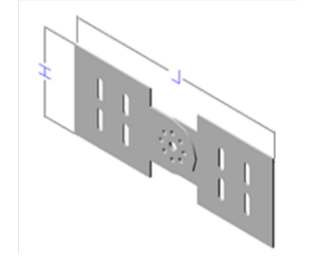
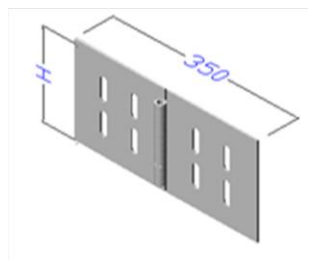
| Code #       | Part Name                               | Shape                                                                               |
|--------------|-----------------------------------------|-------------------------------------------------------------------------------------|
| PG- SPP-50   | <b>Splice Plate</b>                     |    |
| PG- SPP-75   |                                         |                                                                                     |
| PG- SPP-100  |                                         |                                                                                     |
| PG- SPP-110  |                                         |                                                                                     |
| PG- AVC-50   | <b>Adjustable Vertical Connection</b>   |   |
| PG- AVC -75  |                                         |                                                                                     |
| PG- AVC -100 |                                         |                                                                                     |
| PG- AVC -110 |                                         |                                                                                     |
| PG- AHC-50   | <b>Adjustable Horizontal Connection</b> |  |
| PG- AHC -75  |                                         |                                                                                     |
| PG- AHC -100 |                                         |                                                                                     |
| PG- AHC -110 |                                         |                                                                                     |

**2.2.11 Adjustable change level connectors**

**Material:**

Steel / Stainless Steel / Aluminum

**Surface Finish:**

Hot- dip galvanized after fabrication according to ASTM A123 & DIN 50976 - zinc coating thickness on one side 50-60  $\mu$  m (350-420 gm<sup>2</sup>)

- Pre galvanized according to DIN 17162 on both sides 275 gm./m.
- Electrostatic Painting.
- Electroplated.

**For Tray Side Standard height:**  
50 mm - 75 mm - 100 mm - 110 mm

|                     |                    |                                 |                            |                                    |  |
|---------------------|--------------------|---------------------------------|----------------------------|------------------------------------|--|
| How to order :      | (Example)          | PG-TCT50-100 - S - SOT - HD - T |                            |                                    |  |
| Code Description :  | PG : PG-Line       | PCT : Perforated Cable Tray     | 50 : Tray Side Height      | 100 : Tray Width                   |  |
| Material Type :     | S : Steel          | SS : Stainless Steel            | AL : Aluminum              | T:Thickness (1.0/1.25 /1.5 /2.0)mm |  |
| Type of Tray side : | U : U-Shape        | I : Internal Return Flange      | SOT : Snap-On Tray         |                                    |  |
| Surface Finish :    | P : Pre-Galvanized | HD : Hot Dip Galvanized         | ES : Electrostatic Painted | EP : Electroplated                 |  |

### 2.3.1 Trunk Tray Solid Covers

**Material:**

Steel / Stainless Steel / Aluminum

**Surface Finish:**

- Hot- dip galvanized after fabrication according to ASTM A123 & DIN 50976 - zinc coating thickness on one side 50-60  $\mu$  m (350-420 gm<sup>2</sup>)
- Pre galvanized according to DIN 17162 on both sides 275 gm./m.
- Electrostatic Painting.
- Electroplated.

**Standard Thickness:** 1.0 mm – 1.25 mm – 1.5 mm – 2.0 mm

#### 2.3.1 Solid Cover

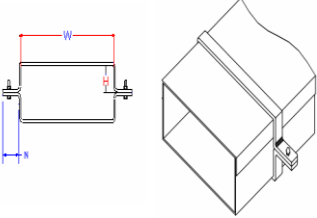
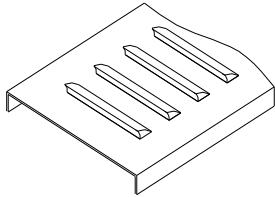
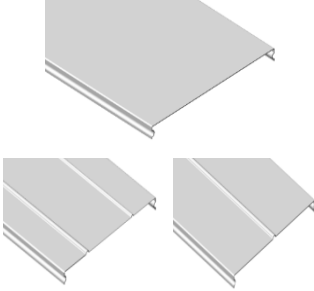
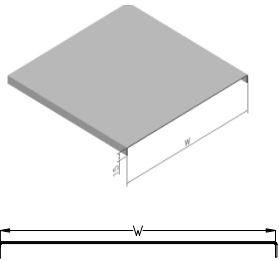
| Cover Clamp                                                                        | Ventilated Cover                                                                   | Snap-On Cover                                                                       | Solid cover with flange                                                              |
|------------------------------------------------------------------------------------|------------------------------------------------------------------------------------|-------------------------------------------------------------------------------------|--------------------------------------------------------------------------------------|
|  |  |  |  |
| <b>PG-CCP</b>                                                                      | <b>PG-VC</b>                                                                       | <b>PG- SOC</b>                                                                      | <b>PG- FC</b>                                                                        |

#### 2.3.2 Horizontal Solid Cover for Cable Tray Fittings

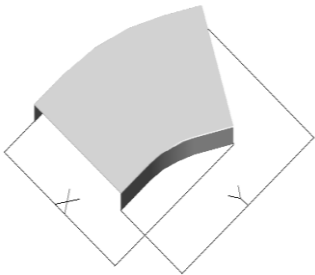
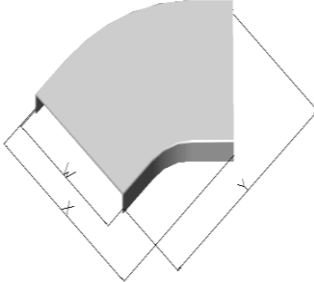
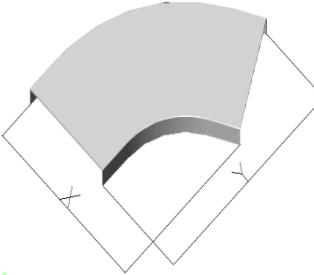
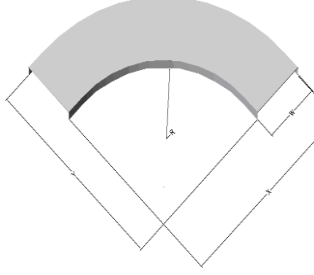
| Cover for H. Elbow 30°                                                              | Cover for H. Elbow 45°                                                              | Cover for H. Elbow 60°                                                               | Cover for H. Elbow 90°                                                                |
|-------------------------------------------------------------------------------------|-------------------------------------------------------------------------------------|--------------------------------------------------------------------------------------|---------------------------------------------------------------------------------------|
|  |  |  |  |
| <b>PG-F-HE30</b>                                                                    | <b>PG-F-HE45</b>                                                                    | <b>PG-F-HE60</b>                                                                     | <b>PG-F-HE90</b>                                                                      |

|                     |                    |                                 |                            |                                    |
|---------------------|--------------------|---------------------------------|----------------------------|------------------------------------|
| How to order :      | (Example)          | PG-TCT50-100 - S - SOT - HD - T |                            |                                    |
| Code Description :  | PG : PG-Line       | PCT : Perforated Cable Tray     | 50 : Tray Side Height      | 100 : Tray Width                   |
| Material Type :     | S : Steel          | SS : Stainless Steel            | AL : Aluminum              | T:Thickness (1.0/1.25 /1.5 /2.0)mm |
| Type of Tray side : | U : U-Shape        | I : Internal Return Flange      | SOT : Snap-On Tray         |                                    |
| Surface Finish :    | P : Pre-Galvanized | HD : Hot Dip Galvanized         | ES : Electrostatic Painted | EP : Electroplated                 |

## 2.3.2 Horizontal Solid Cover for Cable Tray Fittings

### Material:

Steel / Stainless Steel / Aluminum

### Surface Finish:

Hot-dip galvanized after fabrication according to ASTM A123 & DIN 50976 - zinc coating thickness on one side 50-60  $\mu$  m (350-420 gm<sup>2</sup>)

- Pre galvanized according to DIN 17162 on both sides 275 gm./m.
- Electrostatic Painting.
- Electroplated.

**Standard Thickness:** 1.0 mm – 1.25 mm – 1.5 mm – 2.0 mm

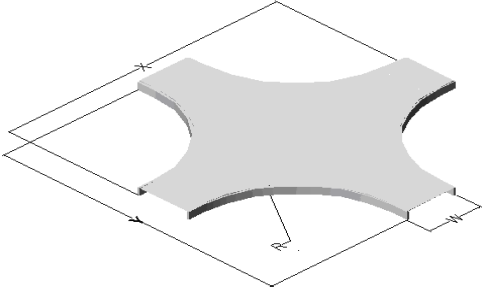
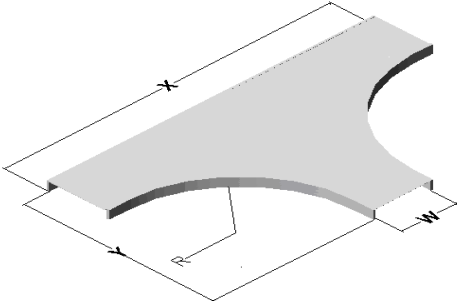
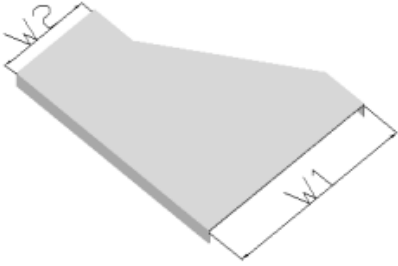
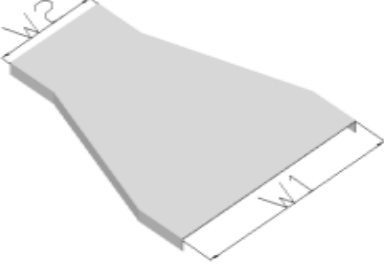
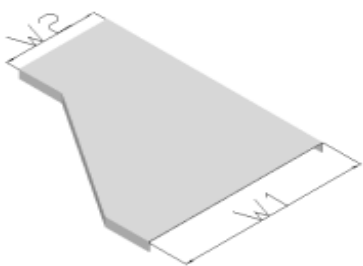
| Horizontal Cross Cover                                                              | Horizontal Tee Cover                                                                 |                                                                                       |
|-------------------------------------------------------------------------------------|--------------------------------------------------------------------------------------|---------------------------------------------------------------------------------------|
|   |   |                                                                                       |
| <p align="center"><b>PG-F-HCRC</b></p>                                              | <p align="center"><b>PG-F-HTC</b></p>                                                |                                                                                       |
| (L/H) H. Reducer Cover                                                              | H. Offset Reducer Cover                                                              | (R/H) H. Reducer Cover                                                                |
|  |  |  |
| <p align="center"><b>PG-F-HRDC-LH</b></p>                                           | <p align="center"><b>PG-F-HRDC-CN</b></p>                                            | <p align="center"><b>PG-F-HRDC-RH</b></p>                                             |

|                     |                    |                                 |                            |                                     |
|---------------------|--------------------|---------------------------------|----------------------------|-------------------------------------|
| How to order :      | (Example)          | PG-TCT50-100 - S - SOT - HD - T |                            |                                     |
| Code Description :  | PG : PG-Line       | PCT : Perforated Cable Tray     | 50 : Tray Side Height      | 100 : Tray Width                    |
| Material Type :     | S : Steel          | SS : Stainless Steel            | AL : Aluminum              | T: Thickness (1.0/1.25 /1.5 /2.0)mm |
| Type of Tray side : | U : U-Shape        | I : Internal Return Flange      | SOT : Snap-On Tray         |                                     |
| Surface Finish :    | P : Pre-Galvanized | HD : Hot Dip Galvanized         | ES : Electrostatic Painted | EP : Electroplated                  |

### 2.3.3 Vertical Solid Cover for Cable Tray Fittings

**Material:**

Steel / Stainless Steel / Aluminum

**Surface Finish:**

Hot-dip galvanized after fabrication according to ASTM A123 & DIN 50976 - zinc coating thickness on one side 50-60  $\mu$  m (350-420 gm<sup>2</sup>)

- Pre galvanized according to DIN 17162 on both sides 275 gm./m.
- Electrostatic Painting.
- Electroplated.

**Standard Thickness:** 1.0 mm – 1.25 mm – 1.5 mm – 2.0 mm

Cover for V. Elbow 30°

Cover for V. Elbow 45°

Cover for V. Elbow 60°

Cover for V. Elbow 90°

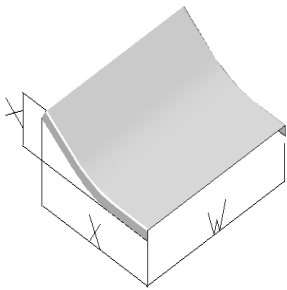

**PG-F-VE30**

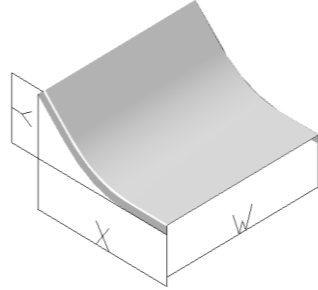

**PG-F-VE45**

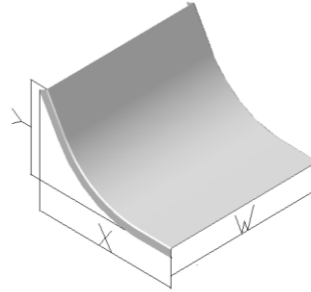

**PG-F-VE60**

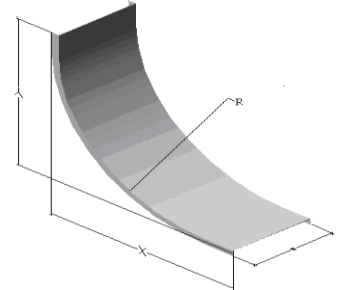

**PG-F-VE90**

#### Vertical Tee Cover

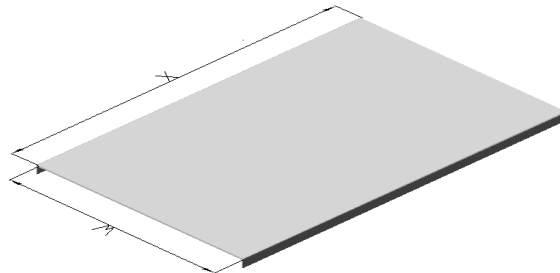

**PG-F-VTC**

|                     |                    |                                 |                            |                                    |
|---------------------|--------------------|---------------------------------|----------------------------|------------------------------------|
| How to order :      | (Example)          | PG-TCT50-100 - S - SOT - HD - T |                            |                                    |
| Code Description :  | PG : PG-Line       | PCT : Perforated Cable Tray     | 50 : Tray Side Height      | 100 : Tray Width                   |
| Material Type :     | S : Steel          | SS : Stainless Steel            | AL : Aluminum              | T:Thickness (1.0/1.25 /1.5 /2.0)mm |
| Type of Tray side : | U : U-Shape        | I : Internal Return Flange      | SOT : Snap-On Tray         |                                    |
| Surface Finish :    | P : Pre-Galvanized | HD : Hot Dip Galvanized         | ES : Electrostatic Painted | EP : Electroplated                 |

## 2.4 Accessories











**Material:**

Steel / Stainless Steel / Aluminum

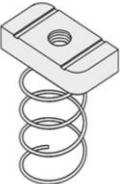
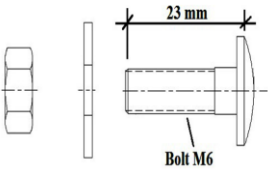
**Surface Finish:**

Hot- dip galvanized after fabrication according to ASTM A123 & DIN 50976 - zinc coating thickness on one side 50-60  $\mu$  m (350-420 gm<sup>2</sup>)

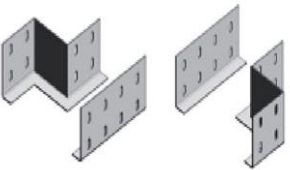
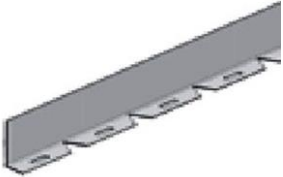
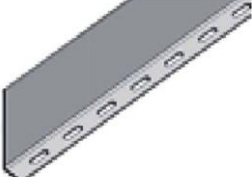
- Pre galvanized according to DIN 17162 on both sides 275 gm./m.
- Electrostatic Painting.
- Electroplated.

|                                                                                     |                                                                                     |                                                                                      |                                                                                       |
|-------------------------------------------------------------------------------------|-------------------------------------------------------------------------------------|--------------------------------------------------------------------------------------|---------------------------------------------------------------------------------------|
| <b>PG-UWB-WP</b>                                                                    | <b>PG-CWB-WP</b>                                                                    |                                                                                      |                                                                                       |
|    |    |                                                                                      |                                                                                       |
| <b>U- Shape Wall Bracket with welded plate</b>                                      | <b>C-Shape Wall Bracket with welded plate</b>                                       |                                                                                      |                                                                                       |
| <b>PG-LWB</b>                                                                       | <b>PG-DCWB-WP</b>                                                                   | <b>PG-SN</b>                                                                         | <b>PG-BWN</b>                                                                         |
|   |   |    |    |
| <b>L - Shape Wall Bracket</b>                                                       | <b>Double C-Shape Wall Bracket W/ welded plate</b>                                  | <b>Spring Nut</b>                                                                    | <b>Bolt with Washer and Nut</b>                                                       |
| <b>PG-3CWB-UC</b>                                                                   | <b>PG-UWB-UC</b>                                                                    | <b>PG-BEP</b>                                                                        | <b>PG-CRSP</b>                                                                        |
|  |  |  |  |
| <b>3-Levels Wall Bracket W/ U-Channel</b>                                           | <b>U- Shape Wall Bracket W/ U-Channel</b>                                           | <b>Blind End Plate</b>                                                               | <b>Center Reducing Splice plate</b>                                                   |
| <b>PG-RHRSP / PG-LHRSP</b>                                                          | <b>PG-HES</b>                                                                       | <b>PG-SES</b>                                                                        | <b>PG-VIES</b>                                                                        |
|  |  |  |  |
| <b>R/H &amp; L/H Reducing Splice plate</b>                                          | <b>Horizontal Elbow separator</b>                                                   | <b>Straight Element separator</b>                                                    | <b>Vertical inside Elbow separator</b>                                                |

How to order : (Example)

|                     |                    |                             |                            |                                    |
|---------------------|--------------------|-----------------------------|----------------------------|------------------------------------|
| Code Description :  | PG : PG-Line       | PCT : Perforated Cable Tray | 50 : Tray Side Height      | 100 : Tray Width                   |
| Material Type :     | S : Steel          | SS : Stainless Steel        | AL : Aluminum              | T:Thickness (1.0/1.25 /1.5 /2.0)mm |
| Type of Tray side : | U : U-Shape        | I : Internal Return Flange  | SOT : Snap-On Tray         |                                    |
| Surface Finish :    | P : Pre-Galvanized | HD : Hot Dip Galvanized     | ES : Electrostatic Painted | EP : Electroplated                 |